

Obsolescence of 5400 & 5400R, Filter Inductor, Radial Leaded

Description of Change: Delevan announces the end of life for our 5400 and 5400R series, Filter Inductor, Radial Leaded. Supply base closure and low market demand has resulted in the decision to remove this series from our product offering.

Delevan P/N:

OBSOLETE PART NUMBER	PRODUCT DESCRIPTION	OBSOLETE PART NUMBER	PRODUCT DESCRIPTION
5400-106G	Radial Leaded, Filter Inductor, 10000 uH , +/- 2%	5400R-106G	RoHS, Radial Leaded, Filter Inductor, 10000 uH , +/- 2%
5400-106H	Radial Leaded, Filter Inductor, 10000 uH , +/- 3%	5400R-106H	RoHS, Radial Leaded, Filter Inductor, 10000 uH , +/- 3%
5400-106J	Radial Leaded, Filter Inductor, 10000 uH , +/- 5%	5400R-106J	RoHS, Radial Leaded, Filter Inductor, 10000 uH , +/- 5%
5400-106K	Radial Leaded, Filter Inductor, 10000 uH , +/- 10%	5400R-106K	RoHS, Radial Leaded, Filter Inductor, 10000 uH , +/- 10%
5400-107G	Radial Leaded, Filter Inductor, 100000 uH , +/- 2%	5400R-107G	RoHS, Radial Leaded, Filter Inductor, 100000 uH , +/- 2%
5400-107H	Radial Leaded, Filter Inductor, 100000 uH , +/- 3%	5400R-107H	RoHS, Radial Leaded, Filter Inductor, 100000 uH , +/- 3%
5400-107J	Radial Leaded, Filter Inductor, 100000 uH , +/- 5%	5400R-107J	RoHS, Radial Leaded, Filter Inductor, 100000 uH , +/- 5%
5400-107K	Radial Leaded, Filter Inductor, 100000 uH , +/- 10%	5400R-107K	RoHS, Radial Leaded, Filter Inductor, 100000 uH , +/- 10%
5400-126G	Radial Leaded, Filter Inductor, 12000 uH , +/- 2%	5400R-126G	RoHS, Radial Leaded, Filter Inductor, 12000 uH , +/- 2%
5400-126H	Radial Leaded, Filter Inductor, 12000 uH , +/- 3%	5400R-126H	RoHS, Radial Leaded, Filter Inductor, 12000 uH , +/- 3%
5400-126J	Radial Leaded, Filter Inductor, 12000 uH , +/- 5%	5400R-126J	RoHS, Radial Leaded, Filter Inductor, 12000 uH , +/- 5%
5400-126K	Radial Leaded, Filter Inductor, 12000 uH , +/- 10%	5400R-126K	RoHS, Radial Leaded, Filter Inductor, 12000 uH , +/- 10%
5400-156G	Radial Leaded, Filter Inductor, 15000 uH , +/- 2%	5400R-156G	RoHS, Radial Leaded, Filter Inductor, 15000 uH , +/- 2%
5400-156H	Radial Leaded, Filter Inductor, 15000 uH , +/- 3%	5400R-156H	RoHS, Radial Leaded, Filter Inductor, 15000 uH , +/- 3%

OBSOLETE PART NUMBER	PRODUCT DESCRIPTION	OBSOLETE PART NUMBER	PRODUCT DESCRIPTION
5400-156J	Radial Leaded, Filter Inductor, 15000 uH , +/- 5%	5400R-156J	RoHS, Radial Leaded, Filter Inductor, 15000 uH , +/- 5%
5400-156K	Radial Leaded, Filter Inductor, 15000 uH , +/- 10%	5400R-156K	RoHS, Radial Leaded, Filter Inductor, 15000 uH , +/- 10%
5400-186G	Radial Leaded, Filter Inductor, 18000 uH , +/- 2%	5400R-186G	RoHS, Radial Leaded, Filter Inductor, 18000 uH , +/- 2%
5400-186H	Radial Leaded, Filter Inductor, 18000 uH , +/- 3%	5400R-186H	RoHS, Radial Leaded, Filter Inductor, 18000 uH , +/- 3%
5400-186J	Radial Leaded, Filter Inductor, 18000 uH , +/- 5%	5400R-186J	RoHS, Radial Leaded, Filter Inductor, 18000 uH , +/- 5%
5400-186K	Radial Leaded, Filter Inductor, 18000 uH , +/- 10%	5400R-186K	RoHS, Radial Leaded, Filter Inductor, 18000 uH , +/- 10%
5400-226G	Radial Leaded, Filter Inductor, 22000 uH , +/- 2%	5400R-226G	RoHS, Radial Leaded, Filter Inductor, 22000 uH , +/- 2%
5400-226H	Radial Leaded, Filter Inductor, 22000 uH , +/- 3%	5400R-226H	RoHS, Radial Leaded, Filter Inductor, 22000 uH , +/- 3%
5400-226J	Radial Leaded, Filter Inductor, 22000 uH , +/- 5%	5400R-226J	RoHS, Radial Leaded, Filter Inductor, 22000 uH , +/- 5%
5400-226K	Radial Leaded, Filter Inductor, 22000 uH , +/- 10%	5400R-226K	RoHS, Radial Leaded, Filter Inductor, 22000 uH , +/- 10%
5400-276G	Radial Leaded, Filter Inductor, 27000 uH , +/- 2%	5400R-276G	RoHS, Radial Leaded, Filter Inductor, 27000 uH , +/- 2%
5400-276H	Radial Leaded, Filter Inductor, 27000 uH , +/- 3%	5400R-276H	RoHS, Radial Leaded, Filter Inductor, 27000 uH , +/- 3%
5400-276J	Radial Leaded, Filter Inductor, 27000 uH , +/- 5%	5400R-276J	RoHS, Radial Leaded, Filter Inductor, 27000 uH , +/- 5%
5400-276K	Radial Leaded, Filter Inductor, 27000 uH , +/- 10%	5400R-276K	RoHS, Radial Leaded, Filter Inductor, 27000 uH , +/- 10%
5400-336G	Radial Leaded, Filter Inductor, 33000 uH , +/- 2%	5400R-336G	RoHS, Radial Leaded, Filter Inductor, 33000 uH , +/- 2%
5400-336H	Radial Leaded, Filter Inductor, 33000 uH , +/- 3%	5400R-336H	RoHS, Radial Leaded, Filter Inductor, 33000 uH , +/- 3%
5400-336J	Radial Leaded, Filter Inductor, 33000 uH , +/- 5%	5400R-336J	RoHS, Radial Leaded, Filter Inductor, 33000 uH , +/- 5%
5400-336K	Radial Leaded, Filter Inductor, 33000 uH , +/- 10%	5400R-336K	RoHS, Radial Leaded, Filter Inductor, 33000 uH , +/- 10%
5400-396G	Radial Leaded, Filter Inductor, 39000 uH , +/- 2%	5400R-396G	RoHS, Radial Leaded, Filter Inductor, 39000 uH , +/- 2%
5400-396H	Radial Leaded, Filter Inductor, 39000 uH , +/- 3%	5400R-396H	RoHS, Radial Leaded, Filter Inductor, 39000 uH , +/- 3%

OBSOLETE PART NUMBER	PRODUCT DESCRIPTION	OBSOLETE PART NUMBER	PRODUCT DESCRIPTION
5400-396J	Radial Leaded, Filter Inductor, 39000 uH , +/- 5%	5400R-396J	RoHS, Radial Leaded, Filter Inductor, 39000 uH , +/- 5%
5400-396K	Radial Leaded, Filter Inductor, 39000 uH , +/- 10%	5400R-396K	RoHS, Radial Leaded, Filter Inductor, 39000 uH , +/- 10%
5400-476G	Radial Leaded, Filter Inductor, 47000 uH , +/- 2%	5400R-476G	RoHS, Radial Leaded, Filter Inductor, 47000 uH , +/- 2%
5400-476H	Radial Leaded, Filter Inductor, 47000 uH , +/- 3%	5400R-476H	RoHS, Radial Leaded, Filter Inductor, 47000 uH , +/- 3%
5400-476J	Radial Leaded, Filter Inductor, 47000 uH , +/- 5%	5400R-476J	RoHS, Radial Leaded, Filter Inductor, 47000 uH , +/- 5%
5400-476K	Radial Leaded, Filter Inductor, 47000 uH , +/- 10%	5400R-476K	RoHS, Radial Leaded, Filter Inductor, 47000 uH , +/- 10%
5400-566G	Radial Leaded, Filter Inductor, 56000 uH , +/- 2%	5400R-566G	RoHS, Radial Leaded, Filter Inductor, 56000 uH , +/- 2%
5400-566H	Radial Leaded, Filter Inductor, 56000 uH , +/- 3%	5400R-566H	RoHS, Radial Leaded, Filter Inductor, 56000 uH , +/- 3%
5400-566J	Radial Leaded, Filter Inductor, 56000 uH , +/- 5%	5400R-566J	RoHS, Radial Leaded, Filter Inductor, 56000 uH , +/- 5%
5400-566K	Radial Leaded, Filter Inductor, 56000 uH , +/- 10%	5400R-566K	RoHS, Radial Leaded, Filter Inductor, 56000 uH , +/- 10%
5400-686G	Radial Leaded, Filter Inductor, 68000 uH , +/- 2%	5400R-686G	RoHS, Radial Leaded, Filter Inductor, 68000 uH , +/- 2%
5400-686H	Radial Leaded, Filter Inductor, 68000 uH , +/- 3%	5400R-686H	RoHS, Radial Leaded, Filter Inductor, 68000 uH , +/- 3%
5400-686J	Radial Leaded, Filter Inductor, 68000 uH , +/- 5%	5400R-686J	RoHS, Radial Leaded, Filter Inductor, 68000 uH , +/- 5%
5400-686K	Radial Leaded, Filter Inductor, 68000 uH , +/- 10%	5400R-686K	RoHS, Radial Leaded, Filter Inductor, 68000 uH , +/- 10%
5400-826G	Radial Leaded, Filter Inductor, 82000 uH , +/- 2%	5400R-826G	RoHS, Radial Leaded, Filter Inductor, 82000 uH , +/- 2%
5400-826H	Radial Leaded, Filter Inductor, 82000 uH , +/- 3%	5400R-826H	RoHS, Radial Leaded, Filter Inductor, 82000 uH , +/- 3%
5400-826J	Radial Leaded, Filter Inductor, 82000 uH , +/- 5%	5400R-826J	RoHS, Radial Leaded, Filter Inductor, 82000 uH , +/- 5%
5400-826K	Radial Leaded, Filter Inductor, 82000 uH , +/- 10%	5400R-826K	RoHS, Radial Leaded, Filter Inductor, 82000 uH , +/- 10%

Delevan Product Series: 5400 & 5400R

Effectivity Date: 11/29/2024

Product Classification: Filter Inductor, Radial Leaded

Replacement Series: None

Expected Effect on Quality/Reliability/Performance: N/A

Implementation Date: Immediately 11/29/2024. No last time buy available.

Issued By: Delevan, Product Line Management

Contact Information:

Delevan

270 Quaker Road, East Aurora, NY 14052

Phone: 716.652.3600

Email: Sean.Anderson@regalrexnord.com

www.delevan.com

**SERIES 5400R
5400**  

High L Filter Inductors

INDUCTANCE (mH) ±10%
TEST FREQUENCY (kHz)
SRF MINIMUM (kHz)
DC RESISTANCE MAXIMUM (OHMS)
CURRENT INCREMENTAL 5% (mA)
CURRENT INCREMENTAL 10% (mA)
DASH NUMBER*

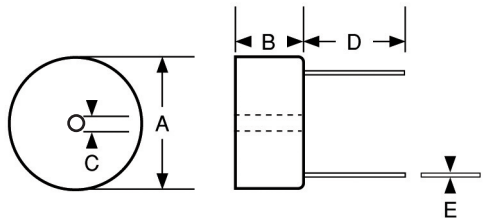
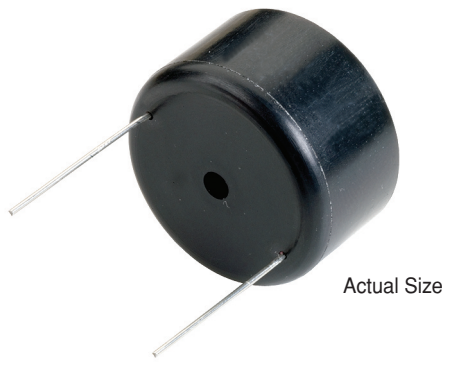

SERIES 5400 POWDER CORE						
-106K	10	1.0	269	1.53	131	204
-126K	12	1.0	235	1.67	120	186
-156K	15	1.0	200	1.88	107	167
-186K	18	1.0	175	2.55	98	152
-226K	22	1.0	150	2.83	88	138
-276K	27	1.0	127	3.15	80	124
-336K	33	1.0	107	3.50	72	113
-396K	39	1.0	92	4.80	66	104
-476K	47	1.0	76	5.31	60	94
-566K	56	1.0	62	5.83	55	86
-686K	68	1.0	48	6.47	50	78
-826K	82	1.0	35	8.89	46	71
-107K	100	1.0	21	9.89	41	65

Optional Tolerances: J = 5% H = 3% G = 2%
*Complete part # must include series # PLUS the dash #
For surface finish information, refer to www.delevanfinishes.com

Physical Parameters

	Inches	Millimeters
A	1.30 ± 0.010	33.020 ± 0.254
B	0.73 ± 0.010	18.542 ± 0.254
C	0.150 ± 0.005	3.810 ± 0.127
D	1.00 Min.	25.4 Min.
E	0.032 Typ.	0.813 Typ.

Marking DELEVAN; 5400 followed by the dash number and tolerance letter; date code (YYWWL). Note an R after 5400 indicates a RoHS component.

Example: 5400R-396G
DELEVAN
5400R-396G
0913A

Operating Temperature Range -55°C to +125°C

Inductance Measured at 1kHz, 100mV with no DC Current

Incremental Current The current at which the inductance will be decreased by a maximum of 5% or 10% from its initial 0 DC value

Packaging Bulk Only

Contact the Factory for additional sizes and electrical configurations.

