

- NOTES:
1. ROTOR & STATOR ARE A MATCHED PAIR. DO NOT INTERCHANGE ROTOR OR STATOR BETWEEN RESOLVERS.
  2. ROTOR AND STATOR TO BE MOUNTED AXIALLY FLUSH ± .010.
  3. CUSTOMER MUST MAINTAIN SHAFT RUNOUT WITH RESPECT TO DATUM 'A' WITHIN .003 T.I.R.

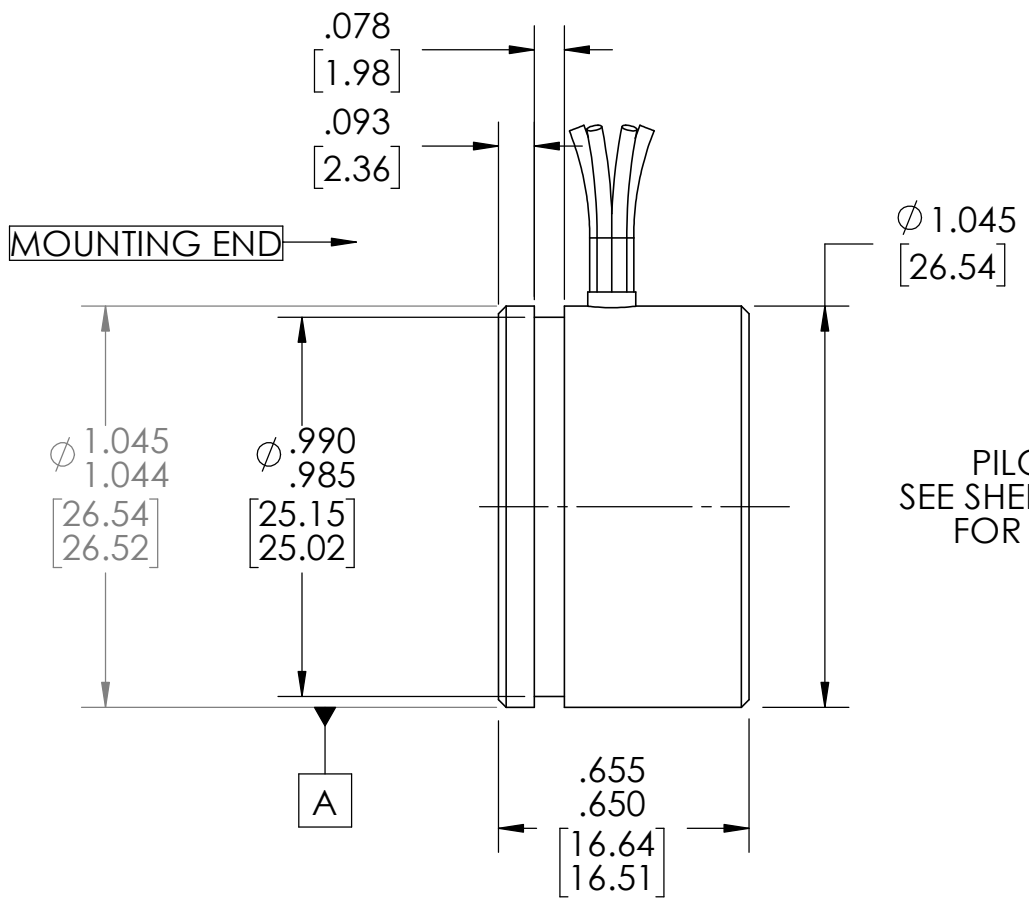

SEE SHEET TWO FOR LEAD OPTIONS

PILOT 401 SHOWN SEE SHEET TWO AND THREE FOR OTHER OPTIONS

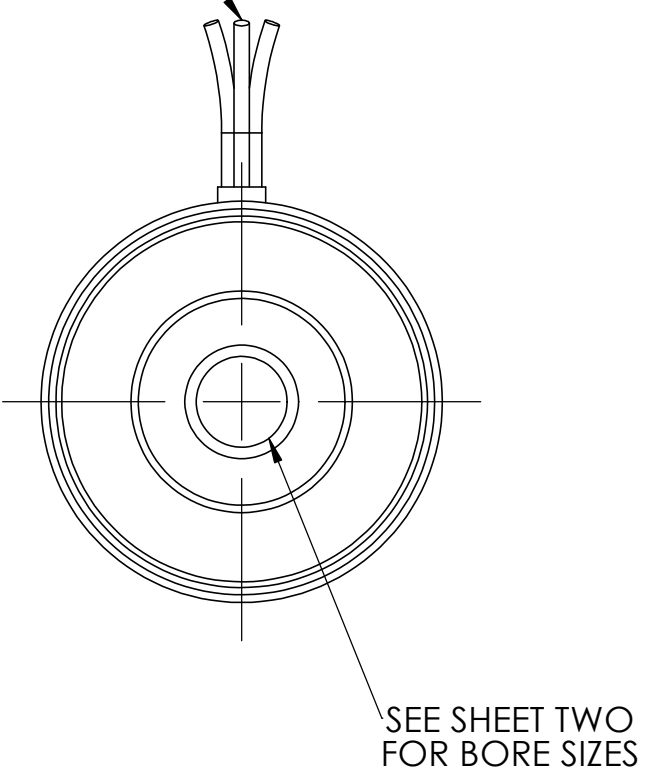

SCHEMATIC

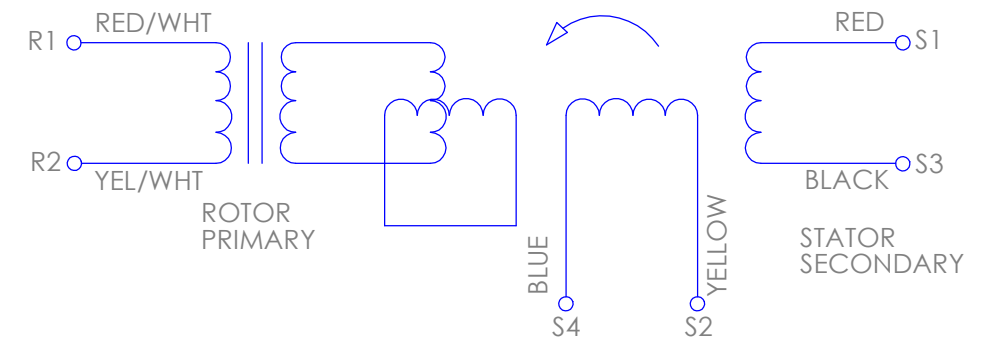

PHASING EQUATION  
 FOR CCW ROTATION OF ROTOR FACING TRANSFORMER MOUNTING FLANGE END.

$$E(S1-S3) = KE(R1-R2) \cos \varnothing$$

$$E(S2-S4) = -KE(R1-R2) \sin \varnothing$$

TECHNICAL INFORMATION		
HIPOT, LEADS TO CASE, 500VAC	Max. mArms	2
HIPOT, INTERPHASE, 250VAC	Max. mArms	2
TEMPERATURE RANGE	°C	-55 TO 155
WEIGHT, APPROX.	oz	1.8
CONTINUOUS SPEED	Max. kRPM	20

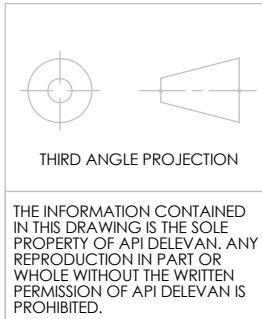
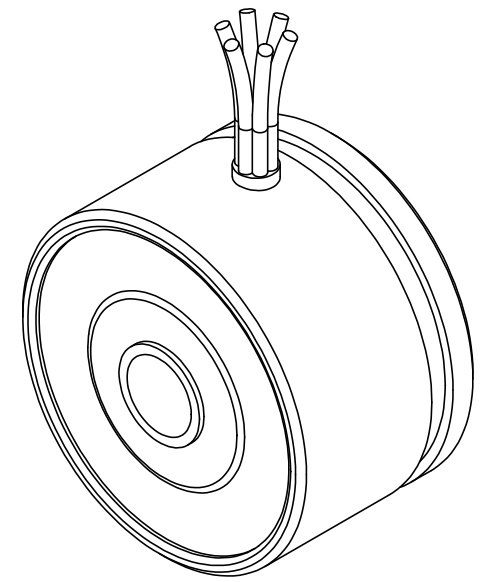

UNLESS OTHERWISE SPECIFIED:  
 DIMENSIONS ARE IN INCHES [mm]  
 DIAMETERS CONCENTRIC .003 [.076] TIR  
 FACES PERPENDICULAR -.003 [.076]  
 INSIDE CORNERS R .015 [.381] MAX  
 INTERPRETATION PER ASME Y14.5M-1994

UNLESS OTHERWISE SPECIFIED:  
 REMOVE ALL BURRS AND BREAK SHARP EDGES -.005/.010[.127/.254]

TOLERANCES:  
 DECIMAL .00±.01 [.254] .000 ±.005 [.127]  
 ANGLE ±0.5°  
 CHAMFER ANGLE ±10°

MACHINE SURFACES 63

MATERIAL	-
FINISH	-
APPROVALS	DATE
DRAWN	-
CHECKED	-
DES ENG	-

**API DELEVAN**  
<http://www.delevan.com>

**10BRCX**

**PART, ASSEMBLY AND ALL COMPONENTS MEET EU ROHS DIRECTIVE**

SIZE	DWG. NO.
B	
SCALE	SHEET 1 OF 3
	CODE IDENT: 99800

REVISIONS					
REV	ECO	DESCRIPTION	DATE	BY	CHECKED
-	-	NEW DRAWING			

# NUMBERING

## 10BRCX-XXX-XXXX-XXXX

PLEASE CONTACT FACTORY FOR OTHER ELECTRICAL AND MECHANICAL OPTIONS.

SIZE  
10

STYLE OF RESOLVER:  
FRAMELESS

PILOT NUMBER	STYLE	WINDING NUMBER	Vrms	KHz	ma Arms	Tr	SPEED	ACCURACY ±arcmin	BORE LETTER	BORE	"B" DIAMETER	CABLE DESIGNATION	CABLE	LEAD	LENGTH
														01	
401	SINGLE GROOVE, Ø1.04[26.416], RADIAL LEADS	001	7	10	50	.50	1	20	A	1/4 INCH	.2500/.2510[6.35/6.375]	02	28 AWG FLYING LEADS	01	12[305]
		002	4	5	43	.50	1	15	B	6 mm	.2362/.2370[6.000/6.020]	03	28 AWG 3 TWISTED PAIRS	02	16[406]
		003	4	5	43	.50	1	20	J	4mm	.1575/.1580[4.000/4.015]	06	28 AWG 3 TWISTED PAIRS W/DRAIN	03	24[609]
403	SINGLE GROOVE, Ø1.04[26.416] AXIAL LEADS	004	7	10	50	.50	1	15				07	28 AWG FLYING LEADS W/TUBING	04	60[1524]
		008	7	5	70	.50	1	15				08	28 AWG HIGH TEMP FLYING LEADS	05	80[2032]
		009	4.25	7	55	.47	1	15				09	24 AWG 3 TWISTED PAIRS	06	120[3048]
405	MOUNTING EARS, Ø.988[25.010] RADIAL LEADS	010	7	10	30	.50	1	30 SPREAD				11	22 AWG 4 TWISTED PAIRS W/TUBING		
		014	3.5	10	65	1.0	1	30 SPREAD				20	RADIATION HARDEN 26 AWG FLYING LEADS		
406	NO GROOVE, Ø.984[25.00] RADIAL LEADS	021	4.7	2.7	55	.475	1	15							
411	SINGLE GROOVE, Ø1.000[25.400], RADIAL LEADS														

SEE SHEET 3 FOR DIMENSIONAL DIFFERENCES

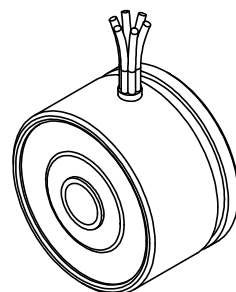

PILOT 401

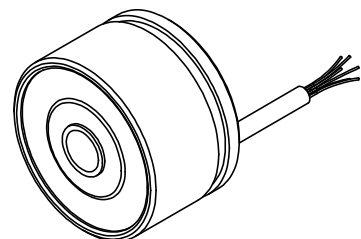

PILOT 403

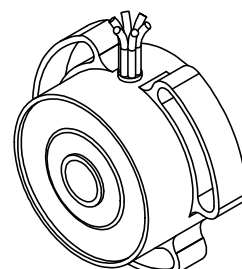

PILOT 405

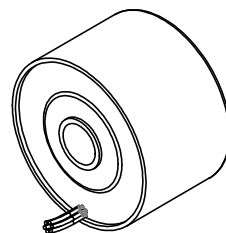

PILOT 406

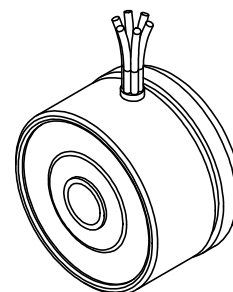

PILOT 411

<p>THIRD ANGLE PROJECTION</p>		<p>UNLESS OTHERWISE SPECIFIED: DIMENSIONS ARE IN INCHES [mm] DIAMETERS CONCENTRIC .003 [.076] TIR FACES PERPENDICULAR .003 [.076] INSIDE CORNERS R .015 [.381] MAX INTERPRETATION PER ASME Y14.5M-1994</p>		<p>UNLESS OTHERWISE SPECIFIED: REMOVE ALL BURRS AND BREAK SHARP EDGES -.005/.010</p>		<p><b>API DELEVAN</b> <a href="http://www.delevan.com">http://www.delevan.com</a></p>	
<p>MATERIAL</p>		<p>TOLERANCES: DECIMAL .00±.01 [.254] .000 ±.005 [.127] ANGLE ±0.5° CHAMFER ANGLE ±10°</p>		<p>MACHINE SURFACES 63</p>		<p><b>10BRCX</b></p>	
<p>FINISH</p>		<p>APPROVALS</p>		<p>DATE</p>		<p>SIZE DWG. NO.</p>	
<p>DRAWN</p>		<p>CHECKED</p>		<p>DES ENG</p>		<p>SCALE SHEET 2 OF 3 CODE IDENT: 58655</p>	

REVISIONS					
REV	ECO	DESCRIPTION	DATE	BY	CHECKED
-	-	NEW DRAWING			

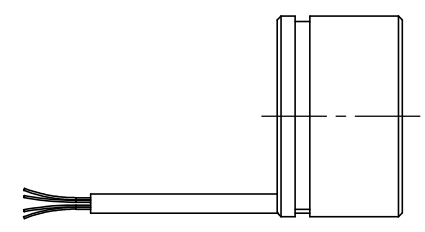

PILOT 403  
DIMENSIONS  
SAME AS 401

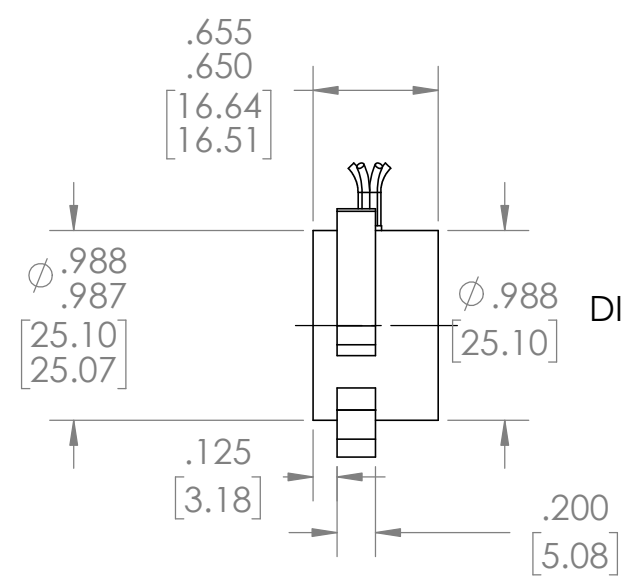
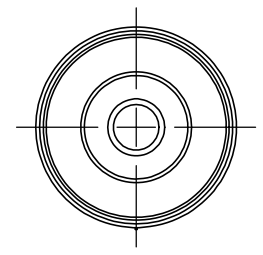

PILOT 405  
DIFFERENCES FROM 401

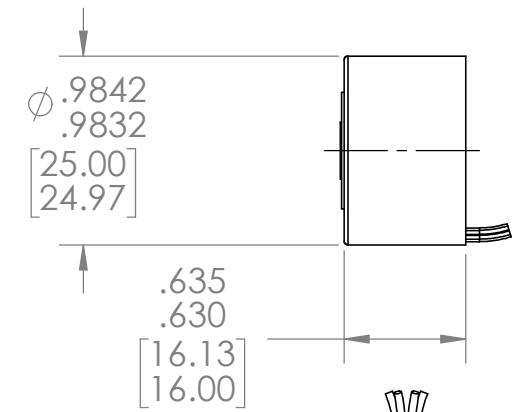
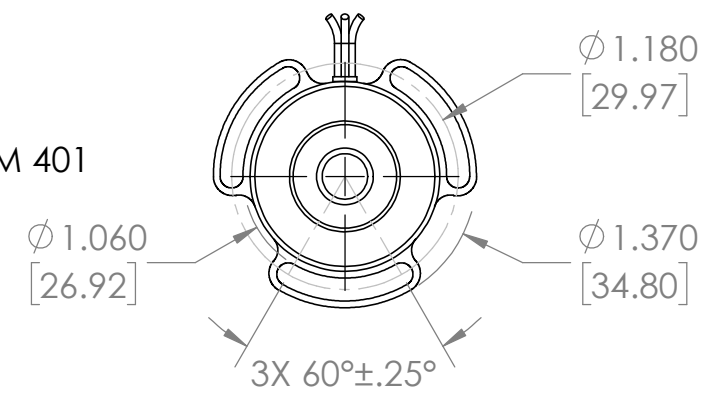

PILOT 406  
DIFFERENCES FROM 401

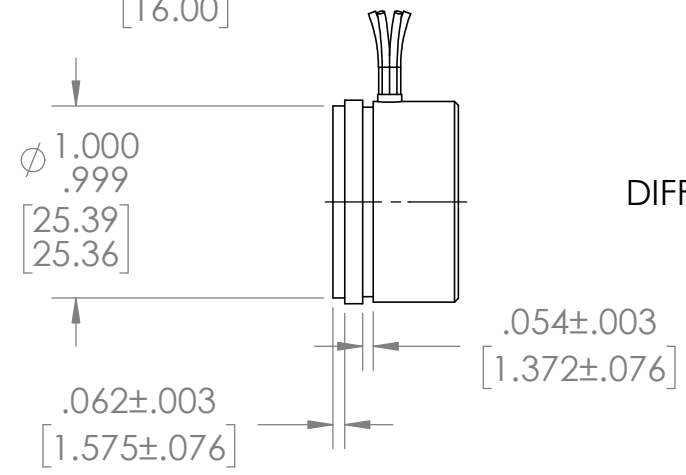
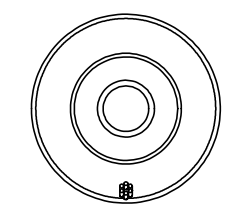

PILOT 411  
DIFFERENCES FROM 401

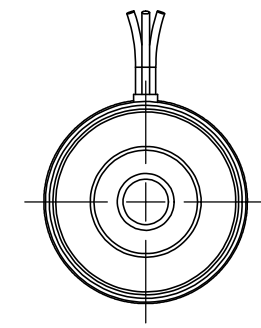

<p>THIRD ANGLE PROJECTION</p>	<p>UNLESS OTHERWISE SPECIFIED: DIMENSIONS ARE IN INCHES [mm] DIAMETERS CONCENTRIC .003 [.076] TIR FACES PERPENDICULAR .003 [.076] INSIDE CORNERS R .015 [.381] MAX INTERPRETATION PER ASME Y14.5M-1994</p>	<p>UNLESS OTHERWISE SPECIFIED: REMOVE ALL BURRS AND BREAK SHARP EDGES -.005/.010</p> <p>TOLERANCES: DECIMAL .00±.01 [.254], .000 ±.005 [.127] ANGLE ±0.5° CHAMFER ANGLE ±10°</p>	<p><b>API DELEVAN</b> <a href="http://www.delevan.com">http://www.delevan.com</a></p>		
	<p>MATERIAL -</p> <p>FINISH -</p>	<p>MACHINE SURFACES <math>\sqrt{63}</math></p> <p>APPROVALS - DATE -</p> <p>DRAWN -</p> <p>CHECKED -</p> <p>DES ENG -</p>	<p><b>10BRCX</b></p>		
<p>THE INFORMATION CONTAINED IN THIS DRAWING IS THE SOLE PROPERTY OF API DELEVAN. ANY REPRODUCTION IN PART OR WHOLE WITHOUT THE WRITTEN PERMISSION OF API DELEVAN IS PROHIBITED.</p>		<p>SIZE DWG. NO. B</p>	<p>SCALE</p>	<p>SHEET 3 OF 3</p>	<p>CODE IDENT: 58655</p>